

DO NOT SCALE FROM THIS DRAWING. USE FIGURED DIMENSIONS IN ALL CASES. VERIFY DIMENSIONS ON SITE AND REPORT ANY DISCREPANCIES TO THE ARCHITECTS IMMEDIATELY. THIS DRAWING TO BE READ IN CONJUNCTION WITH THE ARCHITECTS SPECIFICATION. © THIS DRAWING IS COPYRIGHT AND MAY ONLY BE REPRODUCED WITH THE ARCHITECTS PERMISSION.

06/ License Number: J01 0002219
 Projection: Spatial Reference:
 Projection: ITRF, Irish Transverse Mercator
 X Y: 716253.168 734719.1383
 Reference Index:
 Map Series / Map Sheets
 1:1,000 1283-08
 1:1,000 1284-06
 1:1,000 1285-04
 1:1,000 1284-01
 1:1,000 1285-05
 1:1,000 1283-10
 Vertical Datum:
 MALIN HEAD

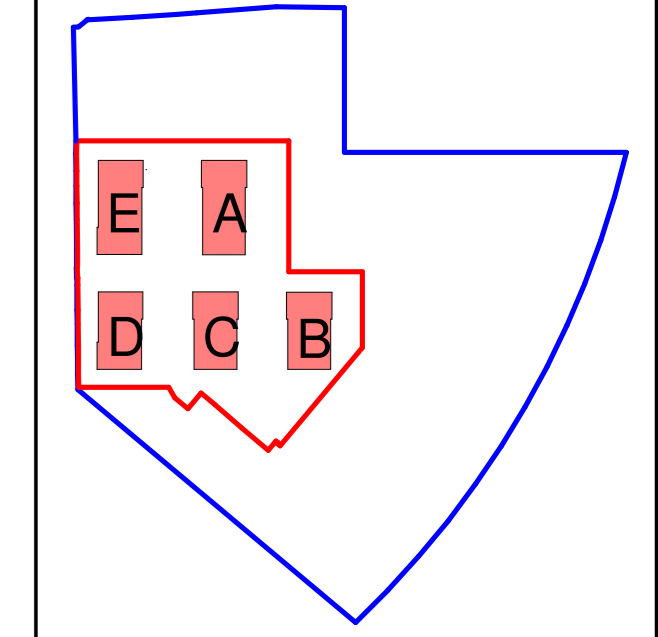

- SHD Site Boundary
- Site Ownership
- Part 5
- Standard Car Parking Space
- Car Club Parking Space
- Motor Bike Parking Space

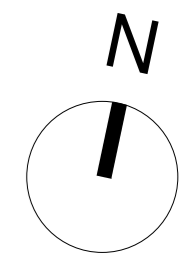
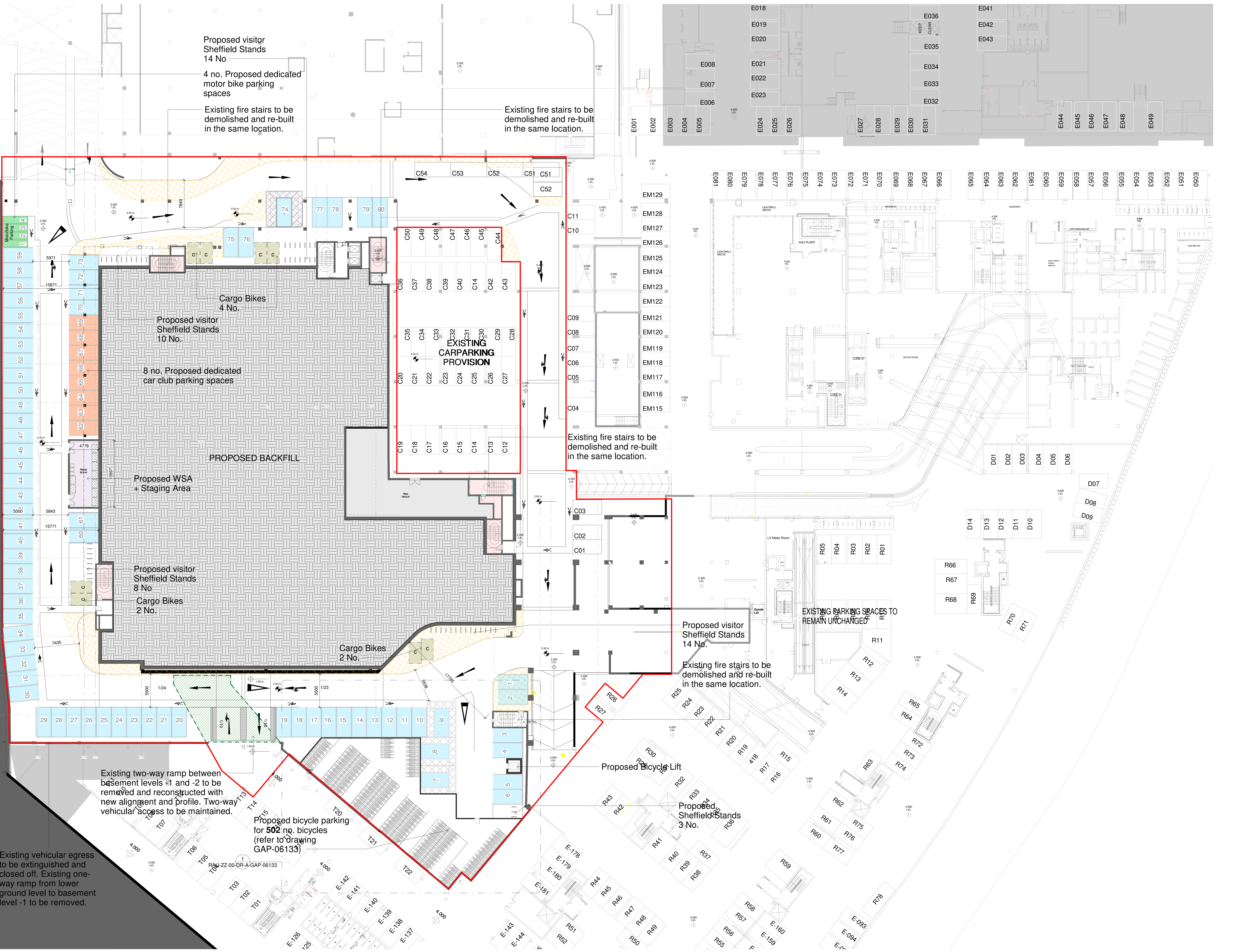

Proposed visitor Sheffield Stands 14 No
 4 no. Proposed dedicated motor bike parking spaces
 Existing fire stairs to be demolished and re-built in the same location.

Existing fire stairs to be demolished and re-built in the same location.

Proposed visitor Sheffield Stands 10 No.
 8 no. Proposed dedicated car club parking spaces

PROPOSED BACKFILL
 Proposed WSA + Staging Area

Proposed visitor Sheffield Stands 8 No
 Cargo Bikes 2 No.

Cargo Bikes 2 No.

Existing fire stairs to be demolished and re-built in the same location.

Proposed visitor Sheffield Stands 14 No.

Existing fire stairs to be demolished and re-built in the same location.

EXISTING PARKING SPACES TO REMAIN UNCHANGED

Existing two-way ramp between basement levels -1 and -2 to be removed and reconstructed with new alignment and profile. Two-way vehicular access to be maintained.

Proposed bicycle parking for 502 no. bicycles (refer to drawing GAP-06133)

Proposed Bicycle Lift

Proposed Sheffield Stands 3 No.

Existing vehicular egress to be extinguished and closed off. Existing one-way ramp from lower ground level to basement level -1 to be removed.

P01 02/07/21 EOB Issued for Planning

Rev	Date	DRN	Description

reddy architecture + urbanism
 reddy architecture + urbanism
 1-103 (01) 488700
 www.reddyarchitecture.com
 E: info@reddyarchitecture.com

Client Details:
 HPREF HSQ Investments Limited

Project Details:
 HSQ Feasibility
 Houston South Quarter, St John's Rd W,
 Kilmsham, Dublin 8

Drawing Title:
 Proposed Car Park Level -1

Job No	Date	Scale/Alt
P19-213D	17/09/21	1:200
Status	Drawn By	IOB
Purpose	Checked By	EOB
Drawing Number	Revision	